



MasterFormat: 07 13 00

NO. 714-F

MAY 2011

MEL-ROL® PRECON™ Blindside/Underslab Membrane

DESCRIPTION

MEL-ROL PRECON is a composite sheet membrane comprised of a non-woven fabric, elastomeric membrane, and W. R. MEADOWS' exclusive, patented plasmatic core (U.S. Patent No. 7,179,761). The plasmatic core is a seven-layer matrix designed for toughness and provides the lowest water vapor transmission (WVT) rating on the market. Once concrete is poured against MEL-ROL PRECON and the concrete cures, a mechanical bond forms that secures the concrete to the membrane.

USES

MEL-ROL PRECON is used as a blindside membrane in vertical applications where access to the positive side is limited. The membrane can also be used for horizontal applications for underslab waterproofing and vaporproofing.

FEATURES/BENEFITS

- Provides a waterproof seal between the membrane and poured concrete wall.
- Helps prevent moisture migration into the structure.

- Acts as a barrier against termites.
- Reduces methane and radon gas intrusion.

PACKAGING

4' (1.2 m) wide x 50' (15.2 m) long rolls, one roll per carton.

STORAGE AND HANDLING

Store membrane cartons on pallets and cover if left outside. Keep materials away from sparks and flames.

APPLICATION

Surface Preparation ... Inspect all surfaces for any conditions detrimental to the proper completion of the work. Surfaces should be structurally sound. Remove debris or any other foreign material that could damage the membrane.

Application Method ... In vertical applications of MEL-ROL PRECON, mechanically attach with fasteners every 12" (31 cm) across the top, within 1/2" (13 mm) of the top edge of the membrane. Install the membrane with the fabric side facing toward the concrete pour.

Prior to application of the blindside membrane, attach MEL-DRAIN™ rolled matrix drainage system from W. R. MEADOWS to lagging or soil retention system.

TECHNICAL DATA

Property	Test Method	MEL-ROL PRECON Results
Color		Black
Thickness	ASTM D 1000	73 mil (1.85 mm)
Low Temp Flexibility	ASTM D 1970, 180° @ -25° F (-32° C)	Pass
Resistance to Hydrostatic Head	ASTM D 5385-93	230' (70 m)
Elongation	ASTM D 412-06	>400%
Tensile Strength, Film	ASTM D 882	9200 psi (63.4 MPa)
Crack Cycling	ASTM C 836 @ -15° F (-36° C)	Pass
Puncture Resistance	ASTM E 154	>210 lb. (>934 N)
Peel Adhesion to Concrete	ASTM D 903	10 lb./in (1754 N/m)
Moisture Vapor Transmission	ASTM E 96B	0.0011 perms
Resistance to Penetration by Termites	Texas A&M Method Percentage of Penetration	0.0%
Resistance to Penetration by Pesticides	ASTM F 2130 Percentage of Penetration	0.0%
Resistance to Fungi in Soil	GSA-PBS 07115 – 16 Weeks	No Effect

CONTINUED ON REVERSE SIDE...

Remove release paper on 4" (10.2 cm) overlap. Apply membrane and roll press into place with a tile type roller.

End Laps ... Overlap membrane 3" (76.1 mm). Prior to overlap, apply POINTING MASTIC from W. R. MEADOWS in area to be lapped. Roll press membrane into POINTING MASTIC. At terminations of membrane, apply 12" (31 cm) wide area of MEL-ROL PRECON FABRIC TAPE with 6" (15.2 cm) on each side of lap edge. For best results, use MEL-PRIME adhesive over 12" (31 cm) area prior to application of tape.

Penetrations and Protrusions ... Detail around all horizontal and vertical penetrations using MEL-ROL LIQUID MEMBRANE (two-component) from W. R. MEADOWS. Apply MEL-ROL LIQUID MEMBRANE by forming a fillet around the pipe or protrusion, overlapping the fabric side of MEL-ROL PRECON and the protrusion a minimum of 2 1/2" (64 mm). If the gap between the protrusion and the membrane is greater than 1/2" (13 mm), apply MEL-ROL PRECON FABRIC TAPE over the fully-cured MEL-ROL LIQUID MEMBRANE (minimum 24 hours cure required). All penetration and protrusion surfaces must be clean, rust-free, and sound prior to application of MEL-ROL LIQUID MEMBRANE.

For horizontal applications involving a cluster of penetrations, consider the use of MEL-ROL LM single-component membrane. Prior to application of MEL-ROL LM, prepare the surfaces of the penetrations as above and provide a block out using 2' x 4' (0.6 x 1.2 m) lumber or other in order to create a "pitch pan" area to receive MEL-ROL LM.

Patching ... Prior to pouring, inspect membrane for punctures or damage and repair as necessary with POINTING MASTIC and/or MEL-ROL PRECON FABRIC TAPE.

Underslab Application ... Refer to ACI 302.1R.17 for sub-grade preparation prior to MEL-ROL PRECON placement.

PRECAUTIONS

Concrete should be poured within 30 days of membrane installation. For installations below 32° F (0° C), contact W. R. MEADOWS technical services.

LEED INFORMATION

May help contribute to LEED credits:

- EA Credit 1: Optimize Energy Performance
- IEQ Credit 3.1: Construction Indoor Air Quality Management Plan: During Construction
- IEQ Credit 7.1: Thermal Comfort – Design
- MR Credit 2: Construction Waste Management
- MR Credit 5: Regional Materials

For CAD details, most recent data sheet, further LEED information, and MSDS, visit www.wrmeadows.com.

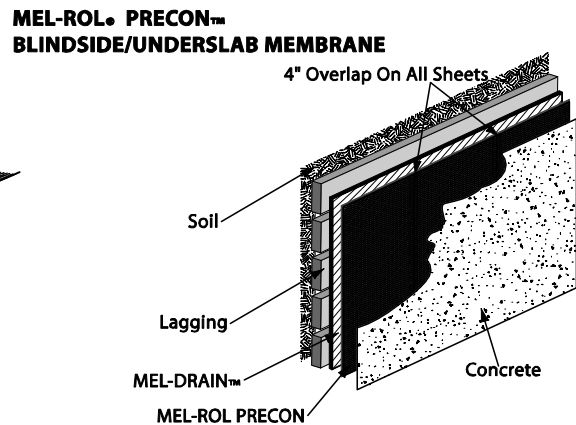
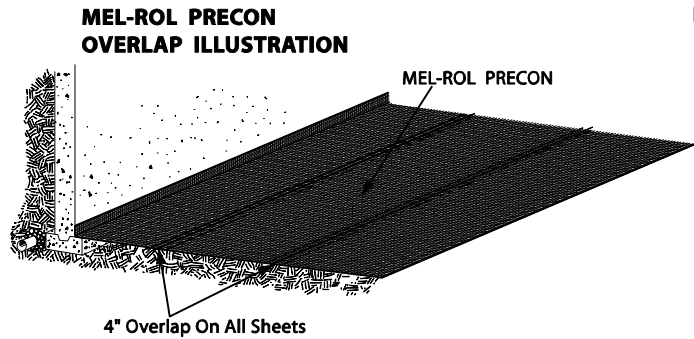

LIMITED WARRANTY

W. R. MEADOWS, INC. warrants at the time and place we make shipment, our material will be of good quality and will conform with our published specifications in force on the date of acceptance of the order. Read complete warranty. Copy furnished upon request.

Disclaimer

The information contained herein is included for illustrative purposes only, and to the best of our knowledge, is accurate and reliable. W. R. MEADOWS, INC. cannot however under any circumstances make any guarantee of results or assume any obligation or liability in connection with the use of this information. As W. R. MEADOWS, INC. has no control over the use to which others may put its product, it is recommended that the products be tested to determine if suitable for specific application and/or our information is valid in a particular circumstance. Responsibility remains with the architect or engineer, contractor and owner for the design, application and proper installation of each product. Specifier and user shall determine the suitability of products for specific application and assume all responsibilities in connection therewith.