

**OUTSIDE CORNER INSTALLATION INSTRUCTIONS**

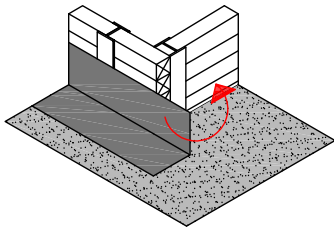

1. Install PRECON according to installation instructions onto soil stabilization system. Allow a minimum of 12" overlap to extend around outside corner.

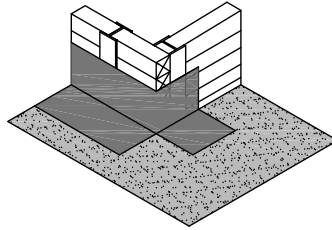

2. Cut PRECON on the horizontal to allow for ease of bending around corner and mechanically fasten according to installation instructions.

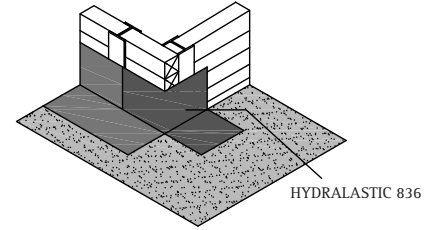

3. Apply HYDRALASTIC 836 to all overlap areas of PRECON that will be accepting the subsequent sheet of PRECON.

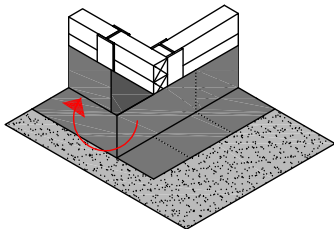

4. Install overlapping PRECON according to installation instructions onto soil stabilization system. Cut PRECON on the horizontal to allow for ease of bending around corner.

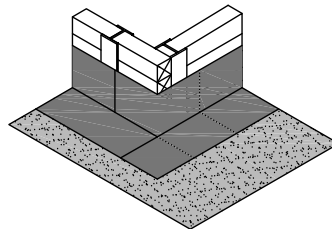

5. Embed overlaps into pre-applied HYDRALASTIC 836 and roll press into place.

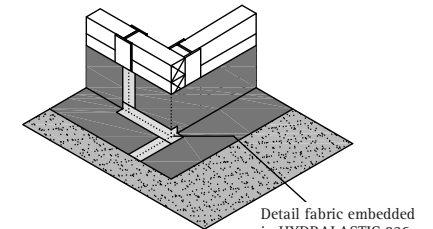

6. Apply HYDRALASTIC 836 at all overlapping joints in a 12" wide application and then fully embed detail fabric into this HYDRALASTIC 836. Terminate all edges with additional HYDRALASTIC 836.



## INSIDE CORNER INSTALLATION INSTRUCTIONS

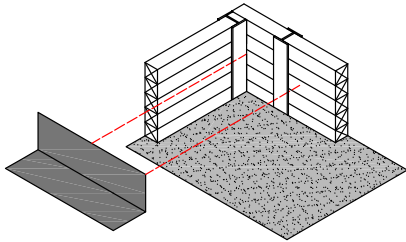

1. Install PRECON according to installation instructions onto soil stabilization system.

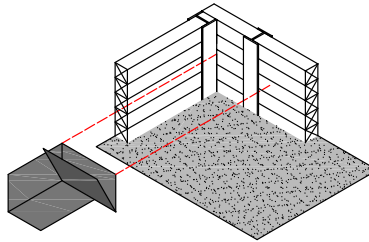

2. Cut PRECON on the horizontal to allow for ease of bending around corner.

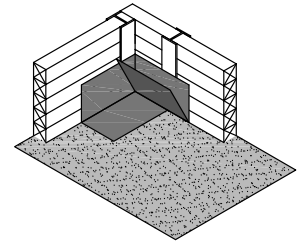

3. Mechanically fasten according to installation instructions.

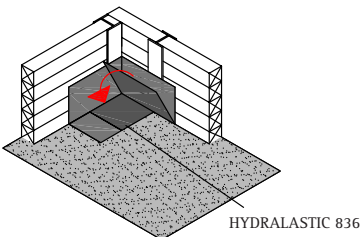

4. Apply HYDRALASTIC 836 to the area of PRECON that will be accepting the PRECON overlap, fold down overlap and embed in the HYDRALASTIC 836. Roll press into place.

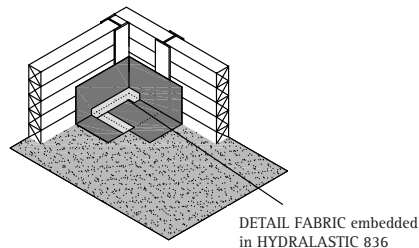

5. Apply HYDRALASTIC 836 at all overlapping joints in a 12" wide application and then fully embed DETAIL FABRIC into this HYDRALASTIC 836. Terminate all edges with additional HYDRALASTIC 836.

