

CEM-KOTE CW PLUS (1ST LAYER RATE OF 1.4lbs/yd<sup>2</sup> (.75kg/m<sup>2</sup>) APPLIED) (APPLIED TO PROPERLY PREPARED SURFACE)

REINFORCING FABRIC HD (EMBEDDED IN CEM-KOTE FLEX)

CEM-KOTE CW PLUS 2ND LAYER RATE OF 1.4lbs/yd<sup>2</sup> (.75kg/m<sup>2</sup>) APPLIED) (TOTAL RATE OF 2.8lbs/yd<sup>2</sup> (1.5kg/m<sup>2</sup>) APPLIED) (APPLIED TO PROPERLY PREPARED SURFACE)

CEM-KOTE FLEX ST (2ND LAYER 31.5 MILS) (APPLIED TO PROPERLY PREPARED SURFACE)

CEM-KOTE FLEX ST (1ST LAYER 31.5 MILS) (APPLIED TO PROPERLY PREPARED SURFACE)

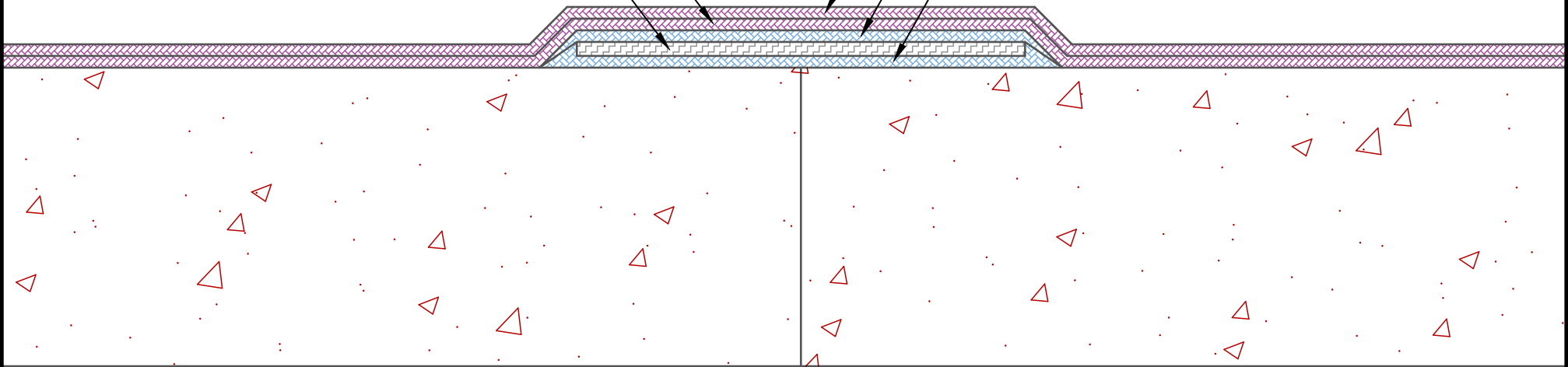

NOTE: DETAIL IS A GUIDE FOR INSTALLATIONS OF W. R. MEADOWS PRODUCTS ONLY. DETAIL MUST BE REVIEWED AND VERIFIED BY A DESIGN PROFESSIONAL FOR SUITABILITY ON THE PROJECT. W. R. MEADOWS DOES NOT ASSUME RESPONSIBILITY FOR ERRORS IN DESIGN OR ENGINEERING.