

DETAILING NOTE:
 1) AT ARCHITECT'S DISCRETION, A FULL 215MIL, REINFORCED APPLICATION OF HRM 714 CAN BE CONSIDERED FOR VERTICAL CONDITIONS FOR A MORE ROBUST SYSTEM
 2) ELIMINATE PROTECTION COURSE ON TOP OF WATERPROOFED AREAS IMMEDIATELY BENEATH VERTICAL CONCRETE SYSTEM.

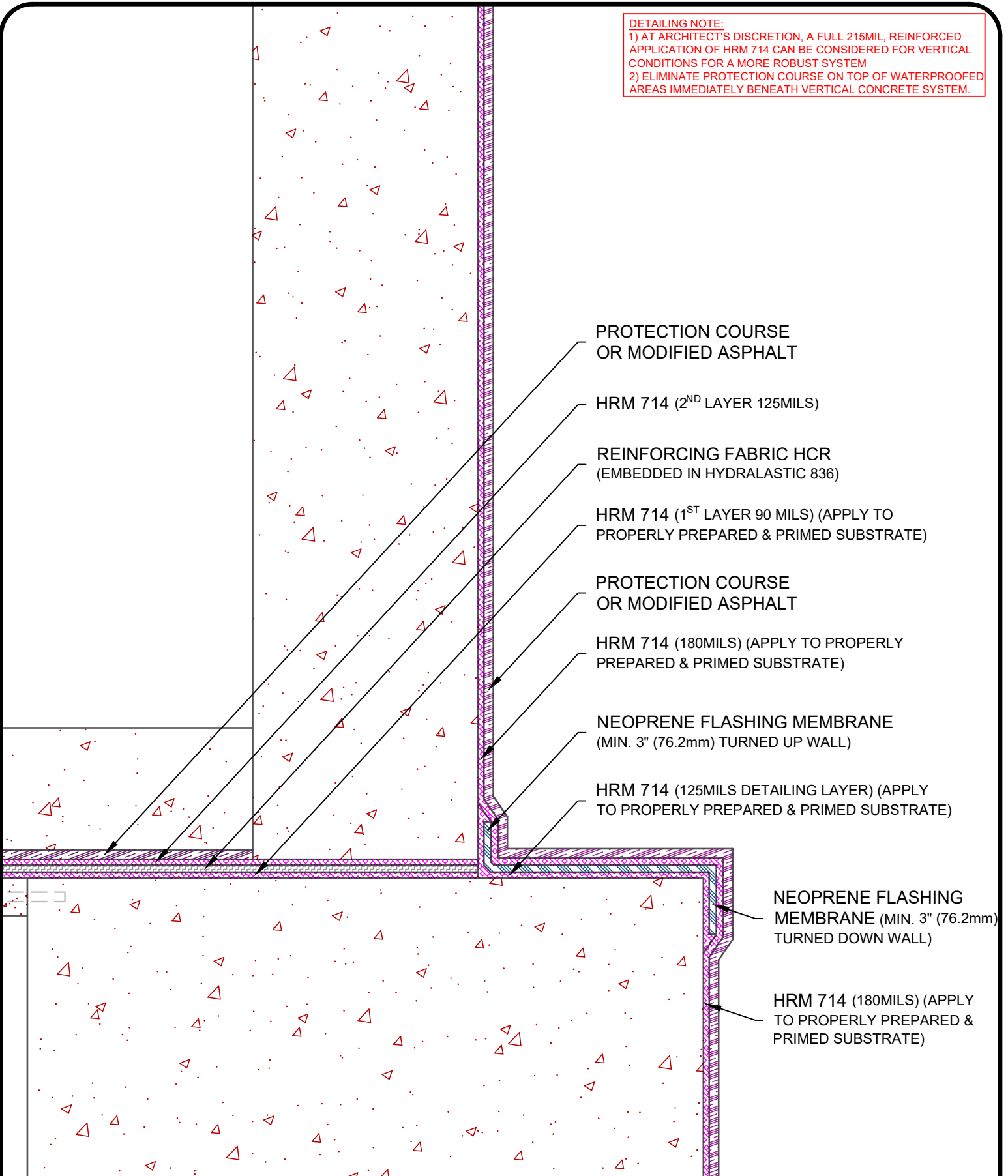

PROTECTION COURSE
OR MODIFIED ASPHALT

HRM 714 (2ND LAYER 125MILS)

REINFORCING FABRIC HCR
(EMBEDDED IN HYDRALASTIC 836)

HRM 714 (1ST LAYER 90 MILS) (APPLY TO
PROPERLY PREPARED & PRIMED SUBSTRATE)

PROTECTION COURSE
OR MODIFIED ASPHALT

HRM 714 (180MILS) (APPLY TO PROPERLY
PREPARED & PRIMED SUBSTRATE)

NEOPRENE FLASHING MEMBRANE
(MIN. 3" (76.2mm) TURNED UP WALL)

HRM 714 (125MILS DETAILING LAYER) (APPLY
TO PROPERLY PREPARED & PRIMED SUBSTRATE)

NEOPRENE FLASHING
MEMBRANE (MIN. 3" (76.2mm)
TURNED DOWN WALL)

HRM 714 (180MILS) (APPLY
TO PROPERLY PREPARED &
PRIMED SUBSTRATE)

NOTE: DETAIL IS A GUIDE FOR INSTALLATIONS OF W. R. MEADOWS PRODUCTS ONLY. DETAIL MUST BE REVIEWED AND VERIFIED BY A DESIGN PROFESSIONAL FOR SUITABILITY ON THE PROJECT. W. R. MEADOWS DOES NOT ASSUME RESPONSIBILITY FOR ERRORS IN DESIGN OR ENGINEERING.