

MEL-DRAIN W/ FILTER FABRIC (FABRIC FACING EARTH) (TERMINATE W/ TERM BAR IF REQ'D)

MEL-ROL LM (60 MILS WET) (MIN. 3" (76.2mm) OVERLAP)
(APPLY MEL-PRIME TO SURFACE PRIOR TO APPLICATION)

DETAIL STRIP OR MEL-ROL STRIP (EXTEND MIN. 6" (152.4mm) ONTO SURFACE) (MIN. 12" (304.8mm) STRIP)
(TERMINATE W/ BEAD OF POINTING MASTIC IF REQ'D) (APPLY MEL-PRIME TO SURFACE PRIOR TO APPLICATION)

COVE OF BEM (FOR TRANSITION)

POINTING MASTIC (TO SEAL MEL-ROL)

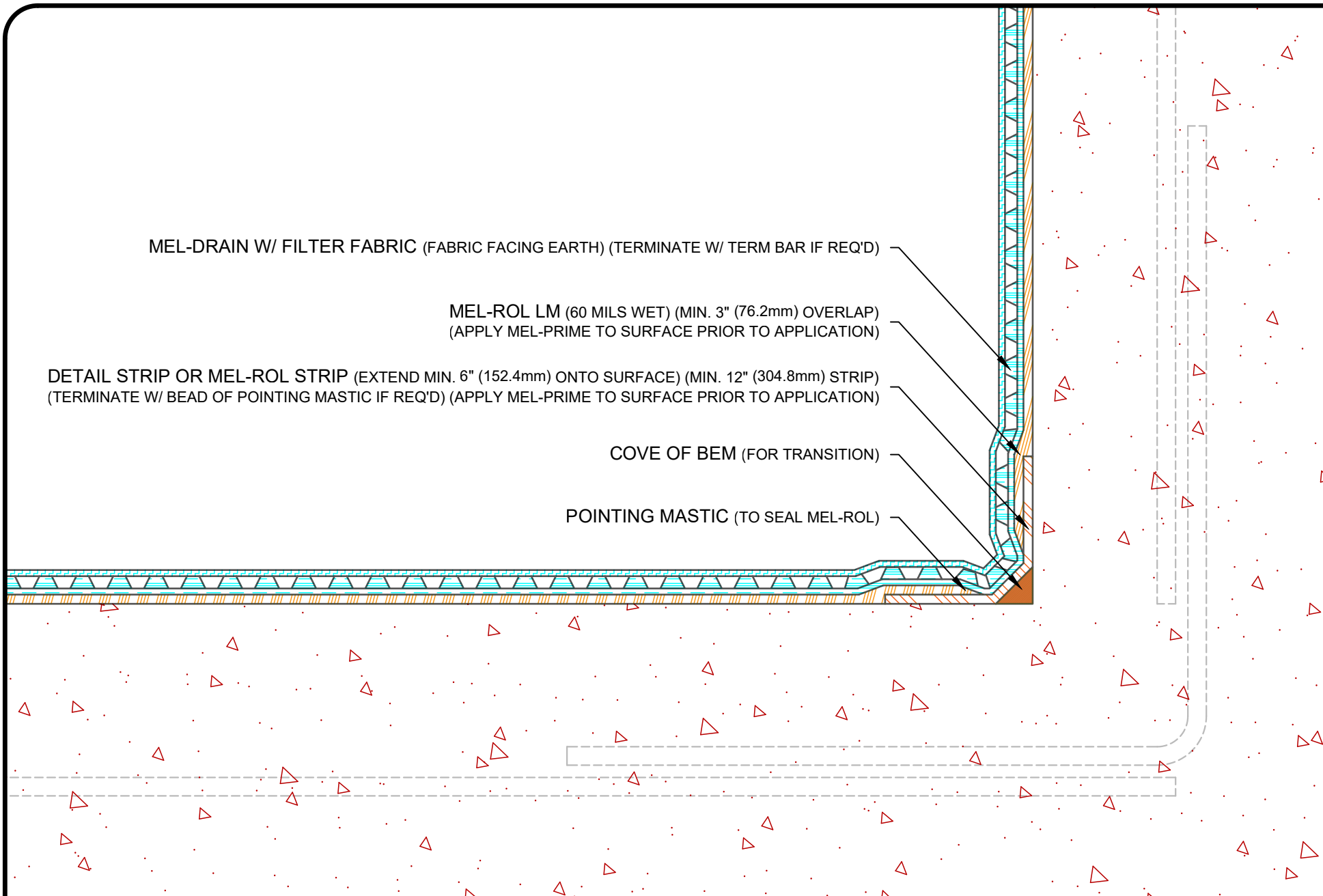

NOTE: DETAIL IS A GUIDE FOR INSTALLATIONS OF W. R. MEADOWS PRODUCTS ONLY. DETAIL MUST BE REVIEWED AND VERIFIED BY A DESIGN PROFESSIONAL FOR SUITABILITY ON THE PROJECT. W. R. MEADOWS DOES NOT ASSUME RESPONSIBILITY FOR ERRORS IN DESIGN OR ENGINEERING.

W. R. MEADOWS INC.

300 INDUSTRIAL DR.
HAMPSHIRE, IL 60140-0338
1-800-342-5976

W. R. MEADOWS

SEALTIGHT

TITLE:

MEL-ROL LM @ INTERIOR CORNER (NO INSULATION) (PLANVIEW)

SCALE:

NTS

DATE:

DEC 28, 2021

DWG NO.:

N/A